

## Mirage™ SoftGel

NASAL MASK

### Components Card

#### Complete system

Europe 1	Europe 2	Europe 3
61605 (S)	61636 (S)	61610 (S)
61606 (M)	61637 (M)	61611 (M)
61607 (L)	61638 (L)	61613 (L)
61608 (LWV)	61639 (LWV)	61614 (LWV)

#### Elbow assembly

(elbow, swivel)

**16399**

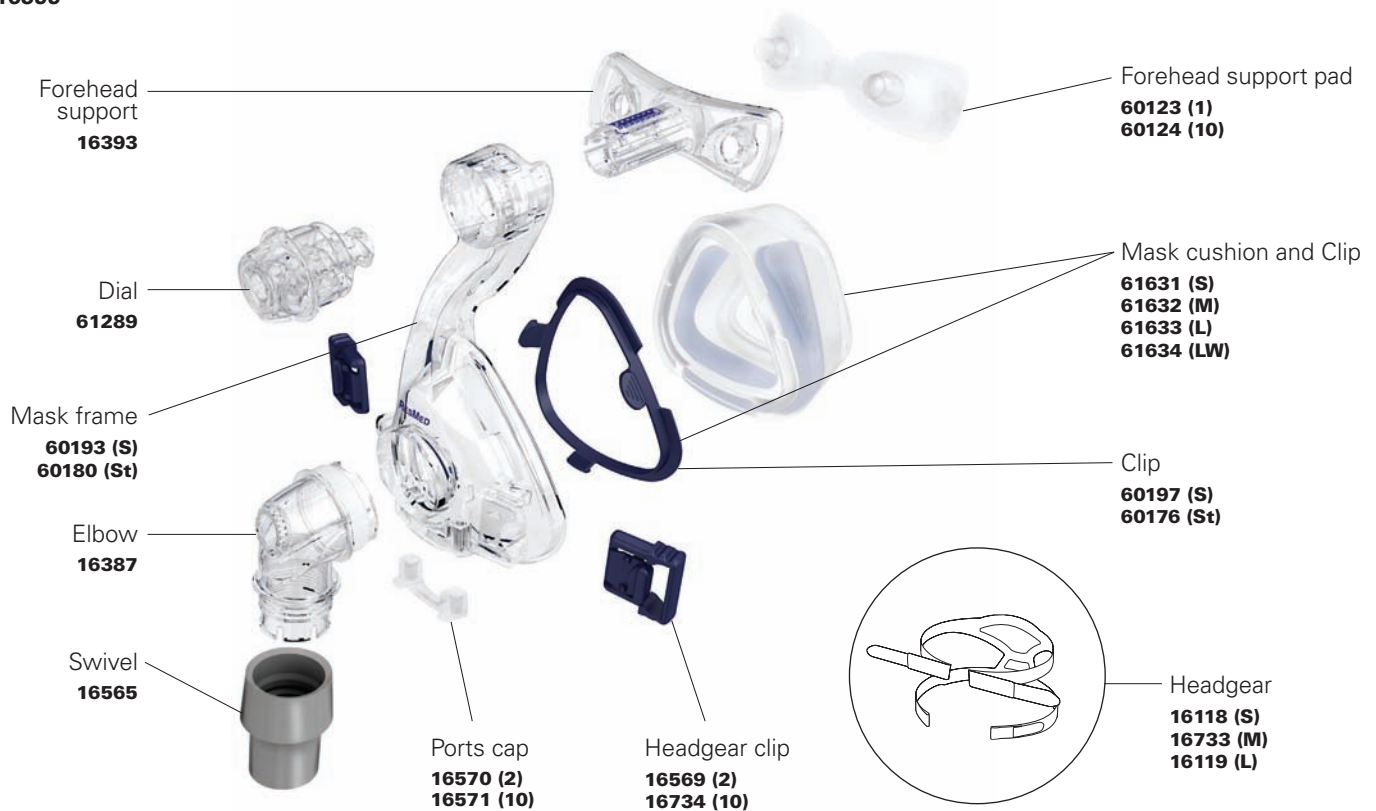

M Medium

L Large

St Standard

LW Large Wide



For details, refer to the  
*Mirage SoftGel Nasal Mask User Guide.*

**Europe 1:** English (UK), French, German and Italian (Switzerland)

**Europe 2:** English, Danish, Finnish, Norwegian and Swedish

**Europe 3:** English, Czech, Dutch (Belgium), French (Belgium), German (Belgium), Greek, Hungarian, Italian, Polish, Portuguese, Russian, Slovak, Spanish and Turkish